

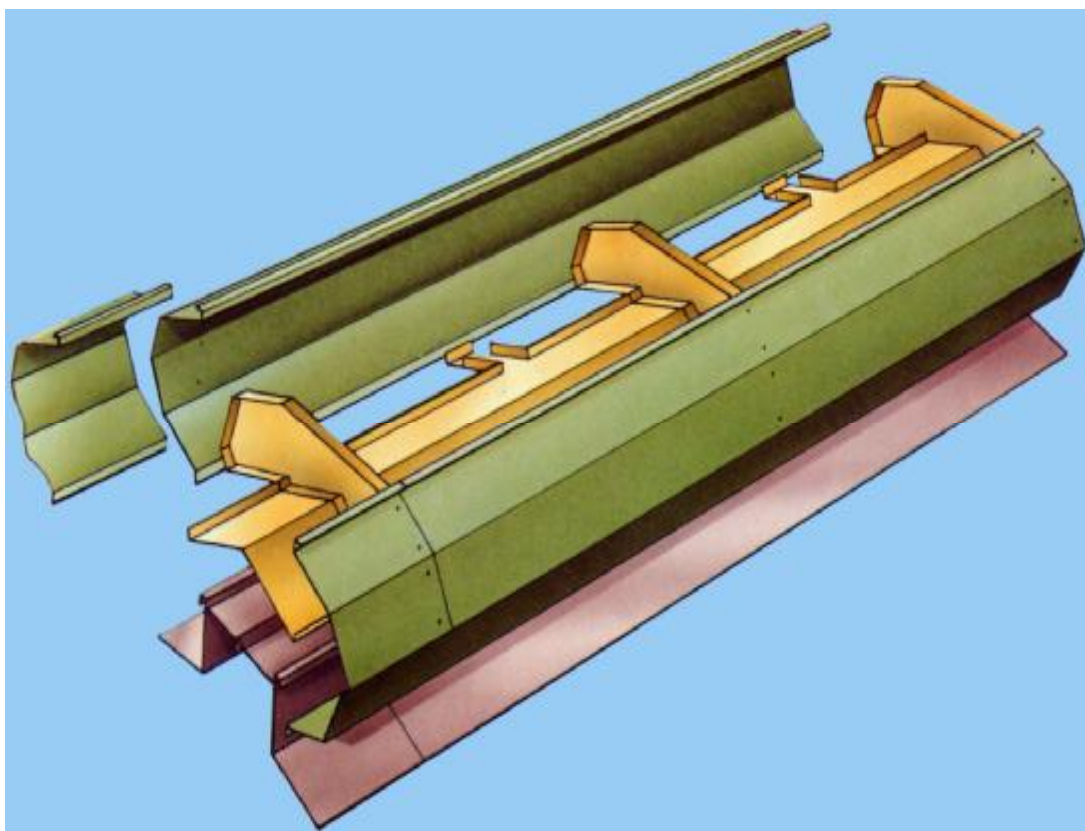

*"Innovative building solutions  
for a sustainable environment"*



# Streamline Ridge Vent

Designers and Specifier's Technical Manual

**Zefyr Group**

Home Farm, Stockton Road, Abberley,

Worcestershire, United Kingdom,

WR6 6AS

Tel (+44) 0870 6001356 Fax (+44) 0870 6001357  
[mail@zefyrgroup.com](mailto:mail@zefyrgroup.com) [www.zefyrgroup.com](http://www.zefyrgroup.com)

# Streamline Ridge Vent



## Introduction

The Zefyr small streamline ridge ventilator range is designed to provide natural ventilation in buildings where nominal ventilation rates are required through solar gain, light engineering processes or general warehousing.

Manufactured primarily from Versacor, Armacor, HP200 Plastisol or Aluminium, and proven over many years to be highly resistant to corrosion, these ventilators have long life characteristics. Their low profile means that they fit unobtrusively onto any building.

The proven performance is based on 40 years service throughout the industry and backed by aerodynamic performance testing independently verified by a leading test authority.

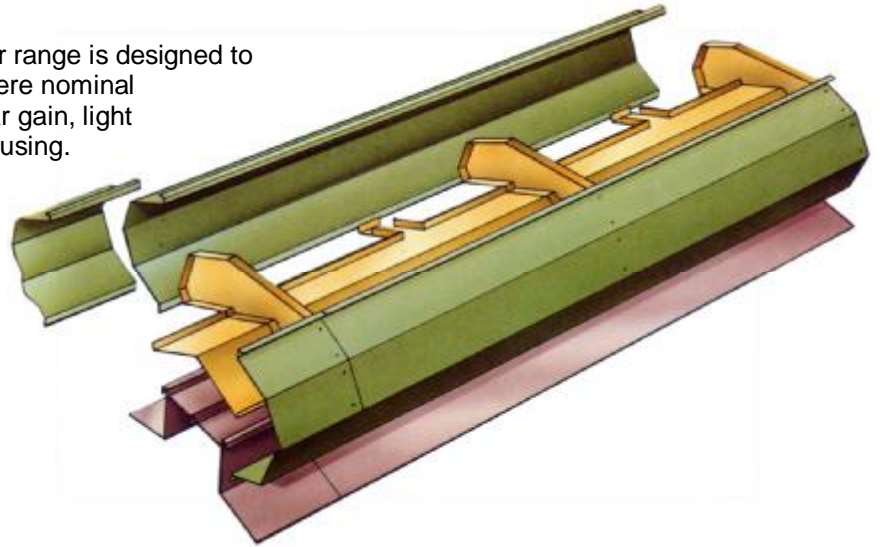

## Application

Usually installed as a continuous ventilator running along the building ridge line. These ventilators are designed to give uninterrupted, but evenly balanced air flow throughout the building.

Streamline ventilators are suitable for installation on various roof constructions.



Existing roof with close ridge purlins

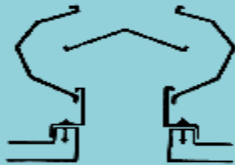

On curb detail

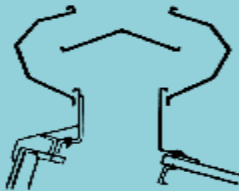

On north light

### NOTE

When ordering, please indicate:  
(a) Roof's slope for suitable device application.  
(b) Roof slope and purlin details for North Light. Existing roof applies on (a) Curb detail.

## Installation

Simple installation procedures are supplied with every ventilator which is manufactured in preformed and predrilled format to ensure ease of assembly. It is important that the roof cladding/steelwork has sufficient clearance so that the ventilator throat is not restricted.

Zefyr ventilators are supplied in 'knocked down' form in order to reduce the cost of packing and shipment to a minimum.

## Weathertightness

All Zefyr ventilators are proven and tested to withstand all weather conditions ranging from monsoons in the Tropics to the icy rains of the Northern Hemisphere.

## Performance

Structurally and aerodynamically tested to produce the optimum coefficients of discharge to ensure maximum performance/minimum cost installations.

## Maintenance

These ventilators require minimum maintenance once installed. We would however, recommend that units fitted with control dampers are operated regularly.

## Birdguards

Available as an optional extra in galvanised steel, PVC coated galvanised steel or aluminium, or to suit the customer's requirements.

## Controls

All units can be fitted with dampers to enable maximum control of the ventilator rates. The method of control can be manual cord or remote electric or pneumatic depending on the customer's requirements.

## Sizes

The Streamline Ridge Ventilator (SRV) is manufactured in two

# Streamline Ridge Vent

standard throat sizes, 250 mm and 500 mm. The units come in 3 m standard lengths and can be installed as individual ventilators or joined lengthways to form one continuous run.



# Streamline Ridge Vent

## Dimensions and weights

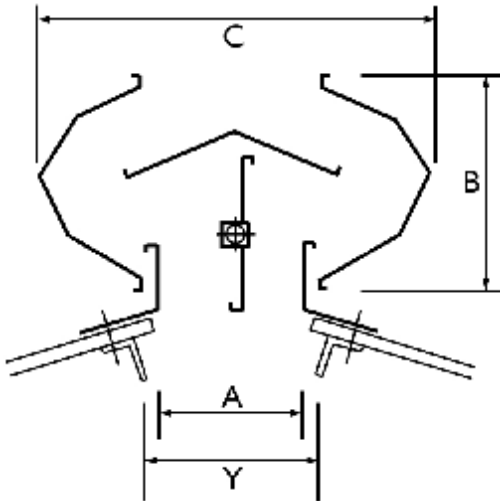

Dimension 'X' not to exceed permissible cantilever of roof sheeting.

Dimension 'Y' must not be less than throat dimension 'A' + 20mm.

A mm	B mm	C mm	Weight Kg/LM
250	410	754	17.8
500	820	1330	3702

## Maintenance

Routine maintenance consists of visual inspection every 12 months to check all internal drainage channels are clear. When dampers are fitted, they should be operated once monthly.

## Control Systems

For simple ventilation systems, ventilators would normally be operated using a hand cord system. If more complicated control systems are required, contact Zefyr for further guidance. Details shown are for general guidance only.

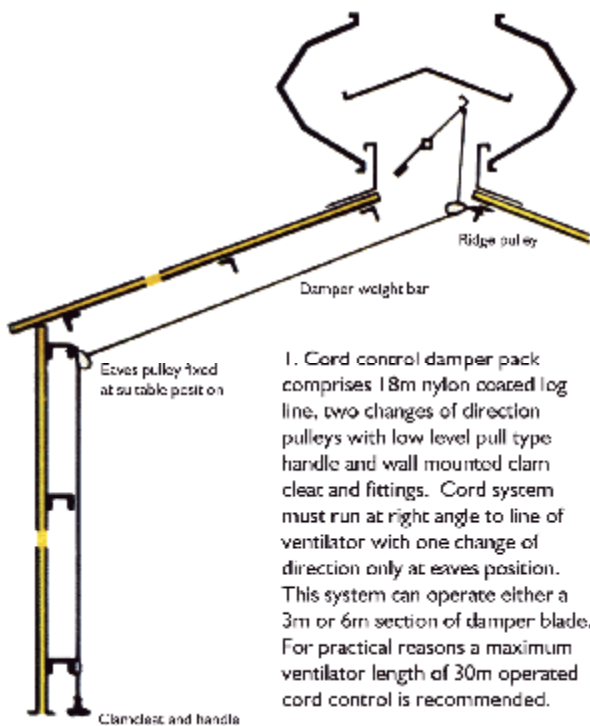

1. Cord control damper pack comprises 18m nylon coated log line, two changes of direction pulleys with low level pull type handle and wall mounted clam clear and fittings. Cord system must run at right angle to line of ventilator with one change of direction only at eaves position. This system can operate either a 3m or 6m section of damper blade. For practical reasons a maximum ventilator length of 30m operated cord control is recommended.

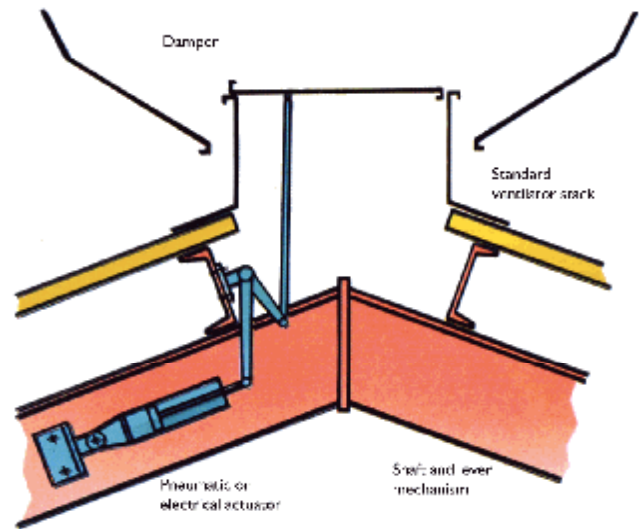

2. Shaft and lever gear can be offered in three variants:  
a) Manual operation, using low level handle operated gearbox with drive shafts.  
b) Pneumatic operation, using double acting pneumatic cylinder, regulator valve and shaft and lever mechanism.  
c) Electric operation, using electrically operated linear actuator and shaft and lever mechanism.